

CINESTARTMPANEL

CineStarPanel
Surface Mount
Installation Manual

CONGRATULATIONS FOR PURCHASING THE CINESTAR PANEL STAR CEILING WELCOME TO THE WORLD OF FIBER OPTIC STAR LIGHTS.

Your package should include the following:

- Acoustical fiber optic panels
- Mounting anchors
- Low voltage jumper cables
- Lead wire(s)
- Hex tools – poker tool
- Anchors template
- 12V power supply
- Cove lighting spacers (optional—not always used. Spacers are used with the Thin-glow LED system.)

Note: Sometimes there will be more than one lead wire and sometimes the wire(s) will already be attached to the power supply.

POWER SPECIFICATIONS:

Each panel draws 12V and 2.5W, or 0.2 amps max.

Note: Some panels will come with a shooting star, which contain two (2) CineStarPanel Board light sources and will increase the panel another 2.5W, for a total of 5W.

TIP: Put latex gloves on to keep panels clean when handling.

INSTALLATION (with 2 people using a stepladder):

Square up the room. A room may look square, but it doesn't mean that it is square. Measure twice since all the panels are aligned off of the first panel. It's alignment in the room is critical. Being just a little out of square with the first panel could result in being way out of square when you get to the end of the room. Take your time squaring up the first panel. Using masking tape, pencil marks, and chalk lines will assist you in keeping the installation square and true. Locate where your first panel will be installed.

RUNNING THE POWER:

Based on site conditions and project design, there will generally be two options for power. The recommended way is to use a Remote Driver and pre-install a CineStarPanel Leader Cable, or pre-wire an 18 AWG wire. The second and alternate way is using the Embedded Driver in the ceiling. (As always, check and observe local building codes.)

TIP: After you finish running the power, after lead wires run, test every panel before it goes up, by plugging lead wire to the LED board, located in the center of the panel.

OPTION 1: REMOTE DRIVER (RECOMMENDED METHOD)

The power supply has connectors for a power cable for the input of the line voltage. The selected outlet for powering the Driver should be controlled from a remote switch, or control system. Locate the Driver in a proper equipment area that is accessible and within 50 feet of the first CineStar ceiling panel (generally in the center of the ceiling.) At this point, connect the CineStarPanel Leader Cable and start daisy chaining the panels together, using the supplied Jumper Cables. Your leader cable should not be longer than 50 feet. Consult with CineStarPanel if a longer leader cable is required.

OPTION2: EMBEDDED DRIVER

Only a licensed electrician should embed the Driver into the ceiling. It may be necessary to install a Driver into an approved electrical enclosure where the line voltage is already located in the ceiling, and running new low voltage wire is not an option. This may be more common in existing older home and retro fits. The Driver is a line voltage device and will require access to it (according to most electrical codes); therefore, a cut out in the panel will be required to access the Driver. Use the CineStarPanel Cut Out Kit (optional) to mark and cut the panel. (Check and observe local building codes.)

TIP: After you finish installation of the power supply and lead wire run, test every panel before it goes up, by plugging lead wire to LED board, located in the center of the panel.

MOUNTING THE FIRST PANEL

TIP: You can use a paint brush extension (available at most hardware stores) to hold the panel in place. No bold

Place the first panel on the ceiling and square in its proper orientation. (This should be performed by at least two people) Push the awl (poker tool) through the center of the round stickers to make an indent in the ceiling. This is done from the finished fabric side of the panel. Once all mounting points are marked on the ceiling, remove the panel.

TIP: While installing the panels, keep the plastic covers of the uninstalled panels on so dust doesn't get on them (especially in construction areas.)

See Chart A and Chart B

STANDARD PANEL CHART (POWER CHART)

POWER SUPPLY	NO. OF PANELS
25W	10 panels
45 W	18 panels
60W	24 panels
80W	32 panels
100W	40 panels
150W	60 panels
200 W	80 panels
250W	100 panels
300W	120 panels

EXAMPLE OF 25W POWER SUPPLY PANEL WIRING

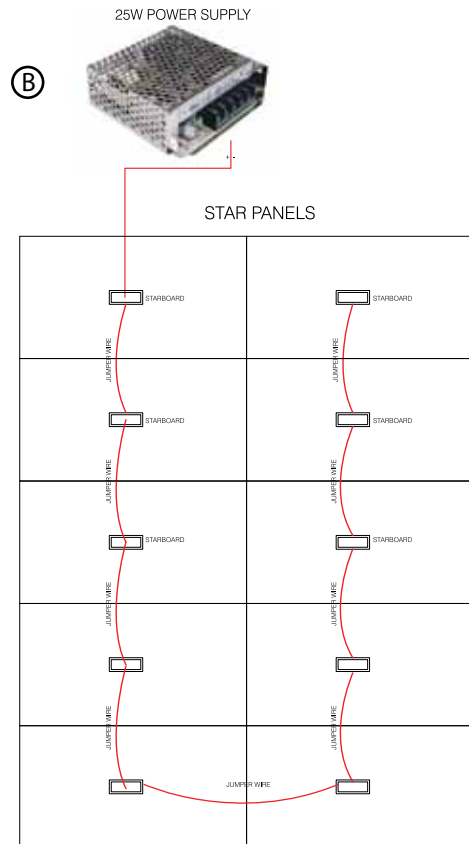

*If you have more than 120 panels, please contact us for assistance.

INSTALLATION STEPS:

Step 1. Position panel. Mark its location.

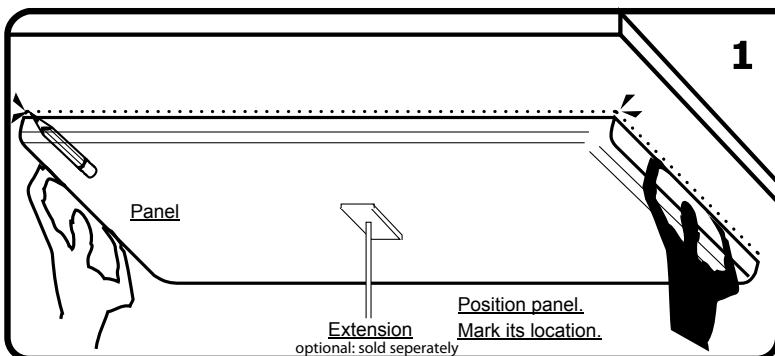

Step 2. Put masking tape on panel face at anchor locations (optional). Position template: push scratch awl (poker tool) through panel at template marking hole. Indent wallboard behind panel.

Note: to mark harder wall material, i.e. concrete block, after marking the panel with the scratch awl, put a common nail in the hole and tap with it.

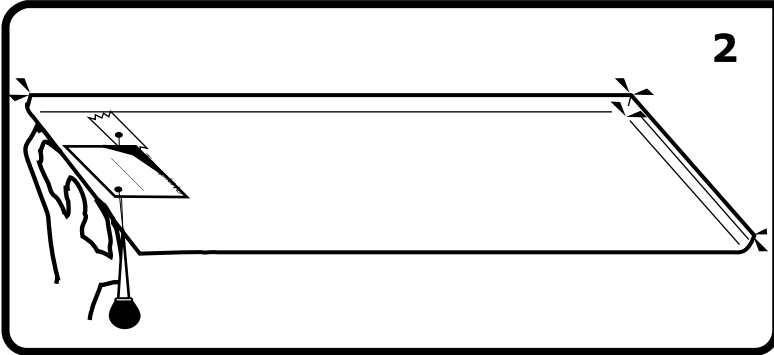

After Step 2, remove panel

Step 3. Screw Feature Presentations panel anchors to wall at pre-marked locations. (Consult manufacturer for recommended fasteners to use with anchors.)

Note: do not over-tighten. Anchors should be hand tight and able to turn on screw shaft.

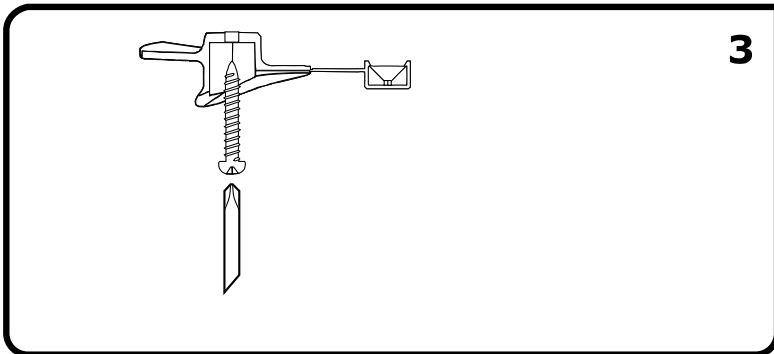

Step 4. Push hex insert firmly into anchor body.

4.1 Push pointed hex driver through panel to engage CineStarPanel anchors.

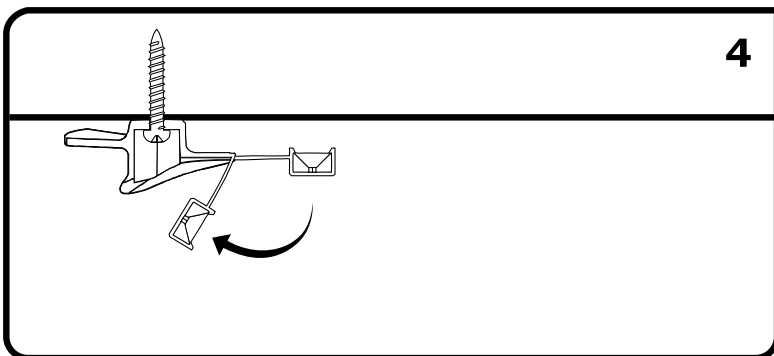

Step 5. Re-position panel. Connect the lead wire to the LED board of the first panel

Note: fully engage hex driver with metal insert before turning.

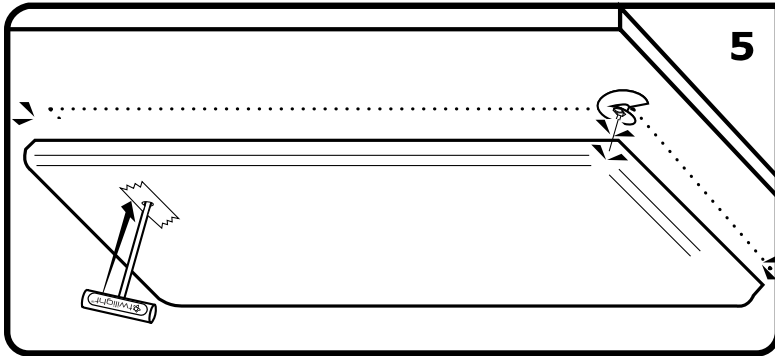

Step 6. Turn CineStar panel anchors counter-clockwise (left) while pushing panel towards wall. Remove masking tape. Lightly rub fabric to hide hole locations.

Note: 1 to 2 turns, do not over-tighten.

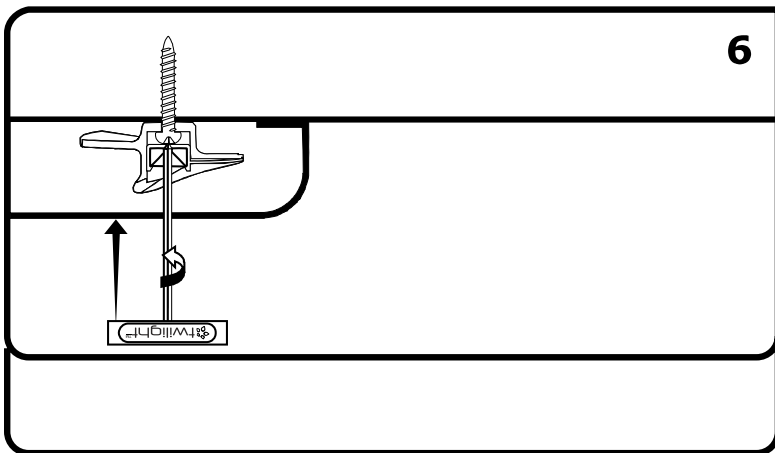

Note: Our panel anchors have been tested to have a pullout strength exceeding 45 lb in standard 6 lb/ft³ fiberglass insulation board.

INSTALLING ADDITIONAL PANELS

Leave the jumper hanging off the side of the first panel so you can connect the next panel. Because of the flat design of the Jumper Cable plugs, you can “sandwich” the Jumper Cables between the ceiling and panel, or run them along the 2” light cove on the back of all Surface Mount Panels. You may find that using white gaffers tape, glue dots, or double sided tape helpful in organizing the Jumper Cables during installation. Up to 12 CineStarPanels can be connected together in any configuration per lead wire. If your installation requires more than 12 CineStarPanels, then add an additional Leader Cable. The total quantity of panel depends on power supply size.

NOTE: See Power Chart on Page 3 for power supply recommendation. Multiple lead wires may be necessary with one power supply (not included in package).

IF USING CUT-OUT TEMPLATE



This template is a universal marking guide and cut-out stencil used for marking the center of a down-light, vent, speaker, or any hole that needs to be marked and cut in a CineStarPanel.

Secure the large thumbtack in the center of the Cut-out Template using double-sided tape. Then use double sided tape or thumbtacks to hold the template centered on the ceiling over the opening or area you need to cut out. Properly align the panel and push it up into the thumbtack(s) (Thumbtacks do not come in the package.)

Take the panel down, note the location of the thumbtack mark on the back of the panel.

Mark the location of the hole on the fabric face of the panel. Now flip the panel over so it is fabric side up. Place the template centered over the hole and insert the awl. Now you have the template so that it rotates around the awl.

Note: The circumference of the hole that is required (this hole should be slightly larger than what is required for the fixture opening, but smaller than the fixtures trim ring.) Place the hot knife in the appropriate slot on the template, and slowly rotate the hot knife and template all the way around the cut and cinch the fabric. Remove the awl and template, peel off the fabric circle and use the serrated knife to cut the two inches of insulation. Your perfectly located hole is done.

CONTROL DIP SWITCH INSTRUCTIONS

PROGRAM:	SWITCH 1	SWITCH 2	SWITCH 3	SWITCH 4	PROGRAM NUMBER
All Off	DOWN	DOWN	DOWN	DOWN	0
All on 50%	UP	DOWN	DOWN	DOWN	1
All on 25%	DOWN	UP	DOWN	DOWN	2
Meteor shower	UP	UP	DOWN	DOWN	3
Sparkle - Summer Night	DOWN	DOWN	UP	DOWN	4
Sparkle Fast - Autumn Breeze	UP	DOWN	UP	DOWN	5
Sparkle really Fast - Island Wind	DOWN	UP	UP	DOWN	6
Shooting star Off	UP	UP	UP	DOWN	7
Shooting star (1 minute)	DOWN	DOWN	DOWN	UP	8
Shooting star (2 minutes)	UP	DOWN	DOWN	UP	9
Shooting star (5 minutes)	DOWN	UP	DOWN	UP	10
Shooting star (10 minutes)	UP	UP	DOWN	UP	11
Shooting star (1 second)	DOWN	DOWN	UP	UP	12
Rain shower	UP	DOWN	UP	UP	13
Random strobe	DOWN	UP	UP	UP	14
All on 100%	UP	UP	UP	UP	15

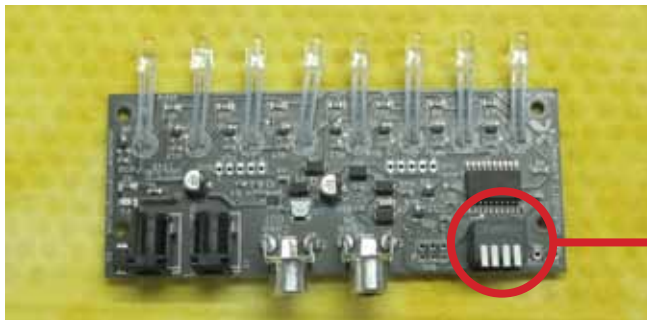

DIP SWITCH